

RECESS MEMBERS

The QUIKLIFT Recess Members are highly durable, reusable and color coded for easy identification. Accessories include a Holding Plate and Holding Rod. A magnetic version is also available. Recess members are a critical part of the casting process, creating a perfect recess for the Ring Clutch. Replacement is required if the Recess Member is damaged or deformed. Nailing is not recommended. Use of the Holding Rod is the preferred method to secure tightly against the form. The Red recess is made specifically for the 1Ton Spread Anchor and L-Anchor (See page 14).

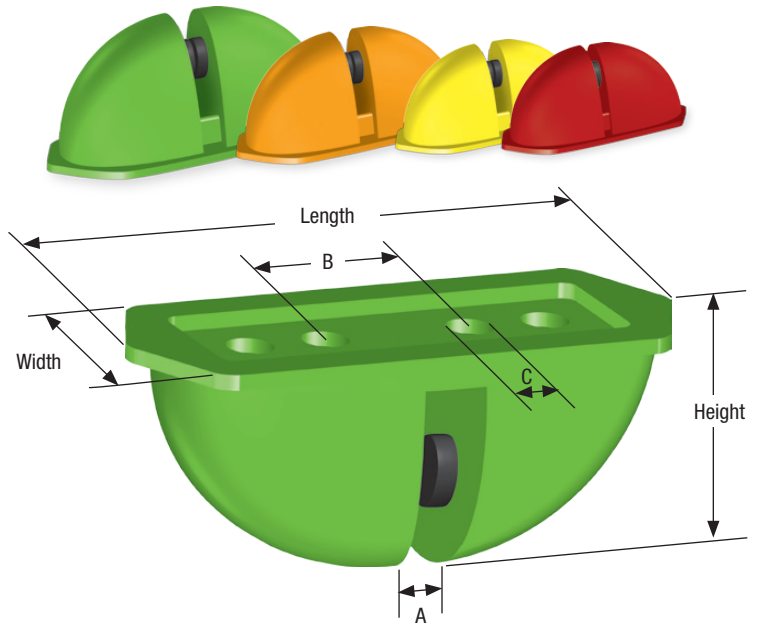

RECESS MEMBER DIMENSIONS

Product Code	Ring Clutch System	Recess Color	Width	Length	Height	A	B	C (Holding Rod Diameter)	Weight Per Piece (lbs)
QL051	2T-3T (QL001)	Red	1-11/16"	4-1/16"	1-3/4"	3/16"	1-3/16"	3/8"	0.19
QL200	2T-3T (QL001)	Yellow	1-11/16"	4-1/16"	1-3/4"	3/8"	1-3/16"	3/8"	0.18
QL062	4-6T (QL002)	Orange	2-1/16"	5-3/16"	2-5/16"	5/8"	1-11/32"	3/8"	0.44
QL121	8T-10T (QL003)	Green	3-1/8"	7-13/32"	3-5/16"	3/4"	1-31/32"	1/2"	1.43

MAGNETIC RECESS MEMBER

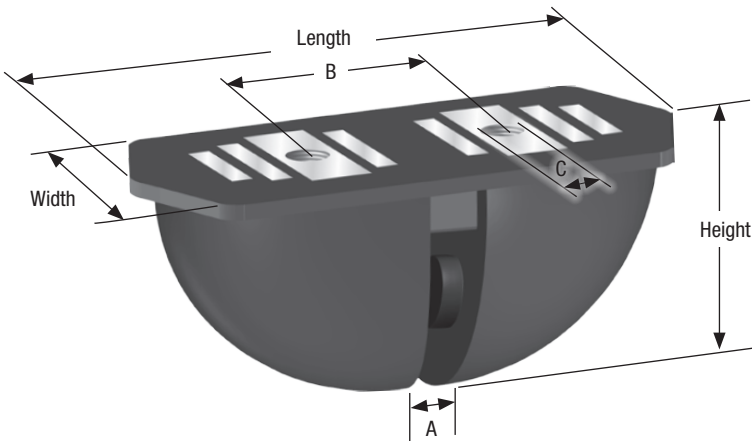

The Magnetic Recess Members are used when steel forms cannot be drilled for the Holding Rod. The QUIKLIFT Magnetic Recess Members are extremely powerful and will easily support the anchors. Caution: vibration and placement of the concrete can cause the Magnetic Recess to move. It is recommended that the anchor is secured to the reinforcement before concrete placement.

MAGNETIC RECESS MEMBER (1 PIECE) DIMENSIONS

Product Code	Ring Clutch System	Recess Color	Width	Length	Height	A	B	C (Holding Rod Diameter)
QL200M	2T-3T (QL001)	Black	1-11/16"	4-1/16"	1-3/4"	3/8"	1-3/16"	3/8"
QL062M	4T-6T (QL002)	Black	2-1/16"	5-3/16"	2-5/16"	5/8"	1-11/32"	3/8"
QL121M	8T-10T (QL003)	Black	3-1/8"	7-13/32"	3-5/16"	3/4"	1-31/32"	1/2"